

Wire Rope Thimbles

G-411



- Hot Dip galvanized steel.
- The standard choice for light duty applications and loading conditions.
- Meets the performance requirements of EN13411-1:2002.

G-411 meets the performance requirements of Federal Specification FF-T-276b Type II, except for those provisions required of the contractor. For additional information, see page 391.

Standard Wire Rope Thimbles

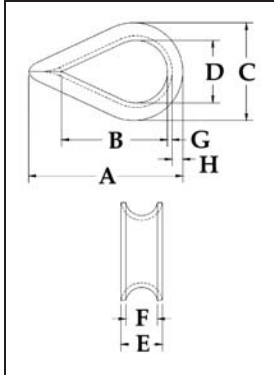

Rope Dia.		G-411 Stock No.	Weight Per 100 (kg)	Dimensions (mm)							
(mm)	(in.)			A	B	C	D	E	F	G	H
3-4	1/8	1037256	1.59	49.3	33.3	26.9	17.5	6.35	4.05	1.25	3.30
5	3/16	1037274	1.59	49.3	33.3	26.9	17.5	7.85	5.60	1.25	3.30
6-7	1/4	1037292	1.59	49.3	33.3	26.9	17.5	9.65	7.10	1.25	3.30
8	5/16	1037318	1.81	54.0	38.1	31.8	20.6	11.2	8.65	1.25	3.30
9-10	3/8	1037336	3.04	60.5	41.4	37.3	23.9	13.5	10.4	1.50	4.06
11-13	1/2	1037354	5.67	70.0	47.8	44.5	28.7	17.5	13.5	2.05	4.83
16	5/8	1037372	15.7	89.0	57.0	60.5	35.1	23.1	16.8	3.30	8.64
18-20	3/4	1037390	21.4	95.5	63.5	68.5	41.4	27.4	19.8	3.55	8.64
22	7/8	1037416	38.4	127	89.0	81.0	47.8	32.3	23.9	4.05	11.2
24-26	1	1037434	44.2	145	108	95.5	63.5	35.3	26.9	4.05	10.4
28-32	1-1/8 - 1-1/4	1037452	79	159	114	109	70.0	44.5	33.3	5.60	12.7

G-414



- Available in Hot Dip galvanized or Stainless Steel (Type 304).
- Meets the performance requirements of EN13411-1:2002.
- Stainless steel recommended for more corrosive environments where greater protection is required.
- Greater protection against wear and deformation of the wire rope eye.
- Longer service life.

G-414 meets the performance requirements of Federal Specification FF-T-276b Type III, except for those provisions required of the contractor. For additional information, see page 391.

Extra Heavy Wire Rope Thimbles

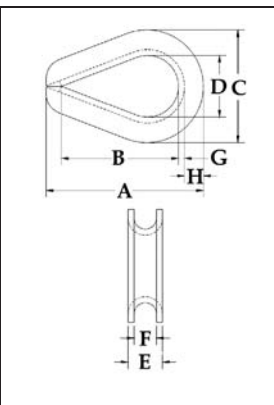

Rope Dia.		Stock No.		Weight Per 100 (kg)	Dimensions (mm)							
(mm)	(in.)	G-414 Galv.	SS-414 Stainless		A	B	C	D	E	F	G	H
* 6-7	1/4	1037639	1037960	2.95	55.5	41.4	38.1	22.4	11.2	7.10	1.50	5.85
* 8	5/16	1037657	1037988	5.35	63.5	47.8	46.0	26.9	14.0	8.65	2.05	7.10
* 9-10	3/8	1037675	1038004	9.80	73.0	54.0	54.0	28.7	16.8	10.4	2.80	8.65
11-12	7/16	1037693	-	15.7	82.5	60.5	60.5	31.8	18.8	11.9	3.30	9.65
* 13-15	1/2 - 9/16	1037719	1038022	23.1	92.0	70.0	70.0	38.1	23.4	13.5	3.55	10.4
* 16	5/8	1037755	1038040	34.3	108	82.5	79.5	44.5	26.2	16.8	4.05	12.7
* 18-20	3/4	1037773	1038068	72	127	95.5	96.5	51.0	33.0	19.8	5.60	16.8
22	7/8	1037791	-	81	140	108	108	57.0	37.3	23.9	5.60	19.1
24-26	1	1037817	-	142	156	114	125	63.5	44.5	26.9	6.35	22.4
28-32	1-1/8 - 1-1/4	1037835	-	181	178	130	149	73.0	47.8	33.3	6.35	28.7
32-35	1-1/4 - 1-3/8	1037853	-	402	230	165	173	89.0	57.2	36.6	9.65	28.7
35-38	1-3/8 - 1-1/2	1037871	-	587	229	159	181	89.0	66.5	39.6	12.7	28.7
40	1-5/8	1037899	-	771	286	203	207	102	76.2	43.7	12.7	35.1
44	1-3/4	1037915	-	805	310	229	216	114	77.7	46.7	12.7	33.3
48-52	1-7/8 - 2	1037933	-	1259	384	305	264	152	85.9	53.0	12.7	38.1
56	2-1/4	1037951	-	1792	435	356	302	178	98.6	60.5	16.0	41.4

* SS-414 sizes available in stainless steel type 304.